

NOTICE: THIS DESIGN WAS ORIGINATED BY AND REMAINS A CONFIDENTIAL, PROPRIETARY DESIGN OWNED BY SOUTHWESTERN INDUSTRIES, INC. IT IS TO BE USED ONLY FOR THE SPECIFIC PURPOSE AND THE EQUIPMENT HEREON. IT IS NOT TO BE REPRODUCED, DISCLOSED OR OTHERWISE USED IN ANY MANNER WITHOUT THE WRITTEN CONSENT OF SOUTHWESTERN INDUSTRIES, INC.

REVISIONS				
REV	DESCRIPTION	ECO	DATE	APPROV
H	REVISED & REDRAWN, SOURCE WAS: INDIANA GENERAL.	14064	9-12-13	BG

EN444-01 MOTOR		
MOTOR SPECIFICATIONS	VALUE	DESCRIPTION
RATED VOLTAGE	60VDC	(VOLTS DC) THIS IS THE VOLTAGE AT WHICH THE MOTOR HAS BEEN RATED.
RATED HORSE POWER	0.33 HP	(HORSE POWER) THIS IS THE HORSE POWER AT WHICH THE MOTOR IS RATED GIVEN THE VOLTAGE.
RATED CURRENT	6.25 amp	(amp) THIS IS THE CURRENT AT WHICH THE MOTOR IS RATED AT.
RATED TORQUE	250 oz-in	(lbs-inch) THE RATED TORQUE OF THE MOTOR PER RATED CURRENT AND VOLTAGE.
RATED RPM	1350 rpm	(rpm) THIS IS THE rpm PRODUCED BY THE MOTOR AT THE RATED VOLTAGE UNDER NO LOAD.
WINDING RESISTANCE (Ra)	1.6 Ohms	(mOhms) - THIS IS THE AMOUNT OF ELECTRICAL RESISTANCE OF THE MOTOR WINDINGS.
MOTOR INDUCTANCE (La)	6 mH	(milli Henry) THIS IS THE AMOUNT OF INDUCTANCE OF THE MOTOR WINDINGS.
TORQUE CONSTANT (Kt)	46 oz-inch/amp	(lbs-inch/amp) THIS IS THE AMOUNT OF TORQUE THAT THE MOTOR CAN PRODUCE PER AMP AT THE RATED VOLTAGE.
SPEED CONSTANT (Ke)	34 V/Krpm	(VOLTAGE PER KILO (THOUSAND) rpm) THIS IS THE AMOUNT OF DC VOLTS REQUIRED FOR EVERY THOUSAND rpm.
ARMATURE INERTIA (Jm)	0.19 oz-inch-sq	(lbs-inch-sq) THIS IS THE AMOUNT OF TORQUE REQUIRED TO ACCELERATE THE MOTOR ROTOR.
THERMAL RESISTANCE (Ct)		(Deg C / Watt) THIS IS THE AMOUNT OF DEGREE RISE OF TEMPERATURE PER EVERY WATT CONSUMED BY THE MOTOR.
NUMBER OF BRUSHES	4	THIS IS THE NUMBER OF BRUSHES ON THE MOTOR.
MOTOR WEIGHT	9.65 lbs	(lbs) THIS IS THE WEIGHT OF THE ACTUAL MOTOR.

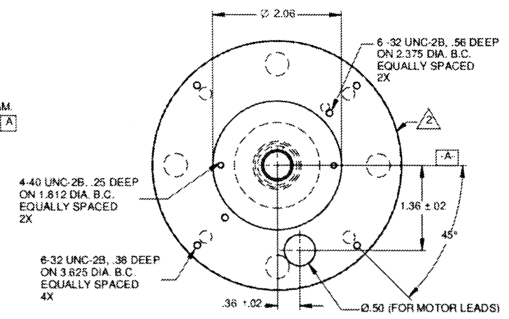
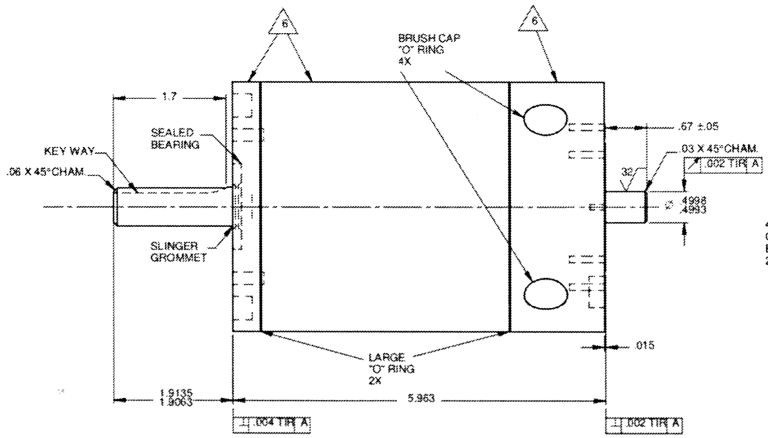
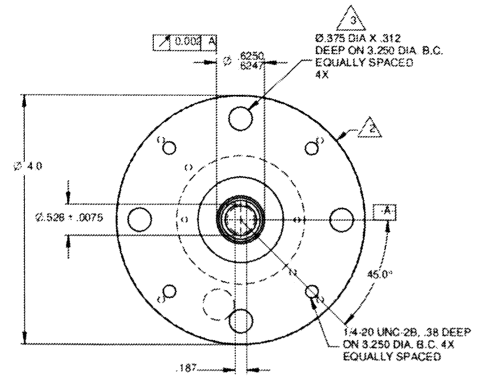
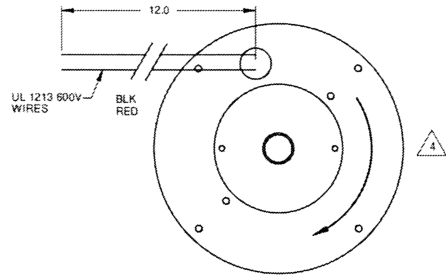

ENDPLAY ARMATURE SHAFT EXTENSION RELATIVE TO REAR SURFACE: .001 MAX IN., .010 MAX OUT

NOTES: UNLESS OTHERWISE SPECIFIED.

1. CHANGES BY VENDOR(S) AFFECTING THESE REQUIREMENTS MUST BE APPROVED BY ENGINEERING.

- 1. FRONT & REAR PLATE ARE ALIGNED AS SHOWN. (B2, C7)
- 2. OPTIONAL HOLE SIZE Ø.425, HOLE USED FOR MOUNTING TEXT FIXTURE. (C7)
- 3. ROTATION OF MOTOR TO BE CW WHEN RED WIRE IS CONNECTED TO PLUS VOLTAGE AND BLACK WIRE IS CONNECTED TO REFERENCE VOLTAGE. (D3)
- 4. ELECTRICAL SPECS AND MECHANICAL DIMENSIONS ARE PER SPECIALTY SPECS. (D6)
- 5. PAINT ENTIRE OD BLACK. (A2, C4, C5)
- 7. FOR MORE INFORMATION SEE EE000096.

SPECIFICATION CONTROL DRAWING

IN CASE OF CONFLICT BETWEEN VENDOR SPECIFICATIONS FOR THIS PART AND SPECIFICATIONS OF THIS DRAWING, THE LATTER CONTROLS.

IDENTIFICATION OF THE "SUGGESTED SOURCE(S) OF SUPPLY" HEREON IS NOT TO BE CONSTRUED AS A GUARANTEE OF PRESENT OR CONTINUED AVAILABILITY AS A SOURCE OF SUPPLY FOR THE ITEM(S) DESCRIBED ON THE DRAWING.

14969		EN444-01		SPECIALTY MOTORS		MOTOR SPEC-EN 444-01	
SW/PN	SUPPLIER P/N	SUPPLIER	MFG P/N	MFG	DESCRIPTION		
SUGGESTED SOURCE(S) OF SUPPLY							
DEC 31, 2013 14:41:46:1 JAN 14 2013		SOUTHWESTERN INDUSTRIES, INC.		DATE		14969	
PART NUMBER: 14969		MFG: BG		DATE: 4/9/13		REV: H	
REMOVE ALL SHARP EDGES		FINISH: 1000		TITLE: MOTOR SPEC-EN 444-01		REV: H	
DIMENSIONS PER SALES V-14.8		TOLERANCES: 1000		SCALE: 1:1		REV: H	
DATE: 12/11/13		THREE WIRE PROTECTION		SCALE: 1:1		REV: H	
NEXT KIT:		APPLICATION: 21008 (BLK OX)		SCALE: 1:1		REV: H	